

GRANDVIEW SCHOOL DISTRICT NO. 200
DISTRICT FENCING PROJECT 2013
GRANDVIEW, WA 98930

ADDENDUM NO. 1

August 14, 2013

This addendum is hereby incorporated into the bidding documents for the above referenced project bidding August 15, 2013, at 2:00 pm local time.

The answers, corrections, clarifications, changes, acceptances and approvals herein shall become an integral and binding part of any contract entered into between the Owner, Contractor and his/her successful sub-bidders.

PRE-BID MEETING & WALKTHROUGH

1. A Pre-Bid Meeting and Walkthrough was held on August 12, 2013 at 10:00 am. Attached is a list of those in attendance and below are the items discussed and questions/answers.
 - I. Question: Are any full size drawings going to be issued for the Fencing Project? Answer: The Drawings at 1:100 scale on 8 ½ x 11 sheet paper give a schematic oversight of the entire project. One reason for a mandatory walkthrough is to give the opportunity for any attending contractor(s) to verify dimensions prior to bidding.
 - II. Question: General Conditions Page 18 Paragraph 3.10.3 states a Project Engineer is required on site full time. Answer: A project engineer is not required to be on site during the District Fencing Project 2013.
 - III. Question: Is weekend work (Saturday, Sunday) okay with the District? Answer: Weekend work by the Contractor is not recommended. Weekend work does not allow for proper supervision and could result in unsatisfactory conditions or costly contractor responsible repairs. If scheduling requires weekend work, there will be no additional cost to owner and a minimum two week notice (14 days) to the District is required for any weekend work.
 - IV. Question: When will the project start? Answer: a "Notice To Proceed" and signed Owner Contractor Agreement is anticipated for Monday August 19th, 2013.

KETCHUM ENTERPRISES INC.

project management

- V. Question: Crimson colored polymer coated fence lead time is at least a month out? Answer: The Grandview High School is the only “crimson colored poly coated” fence for the project. The High School fence portion will be looked at according to substantial completion dates once a supply lead time is agreed upon. No more than 45 days from the date of the Notice To Proceed will the polymer coated High School Fence be allowed to be installed. The remainder of the Project is to abide by the contract documents.
- VI. Question: Is the fencing spec 9 gauge core? Answer: Yes, 9 gauge core. Galvanizing and Polymer coat is additional gauge to the 9 gauge core.
- VII. Question: Specification Section 323113 Paragraph 2.1.A.2.b “Class 2” does not state whether that is to be Class 2 “A” or “B”. Answer: Class 2 B.
- VIII. Question: Does the District want gravel underneath the mow-strip? Answer: Yes, 4 inch thick concrete mow strip over 4 inches compacted gravel, $\frac{3}{4}$ minus, vibratory compacted over vibratory compacted native soil as per detail.
- IX. Question: What type of testing and/or field quality control is required for concrete mix? Answer: A mix design certification showing minimum specification requirements are met for each delivered load shall be collected and reviewed by Contractor and delivered daily to Architect.
- X. Question: Fence Posts to be installed in existing concrete is to be core drilled? Answer: Yes, core drill fence posts to be installed in existing concrete walks. Concrete to be installed around fence posts installed in existing concrete.
- XI. Question: Are the roll gates to be “roll gates” or “cantilevered gates”? Answer: Roll gates designated on drawings are to be cantilevered gates, unless specifically noted as “roll gate”. See addendum revised drawings for clarification.
- XII. Question: Are gates to be self-closing? Answer: No, gates are to have typical heavy duty manufacturer hinges and not be self-closing.
- XIII. Question: Are “foot locks” to be installed? Answer: No, foot locks are not to be installed.
- XIV. Question: What type of swing is desired for swing gates? Answer: 180 degree swing for gates.
- XV. Question: Fencing to be powder coated or polymer coated? Answer: The fencing designated as poly or polymer coated is to be polymer coated over galvanized 9 gauge core fence fabric, not powder coated.
- XVI. Clarification: All fencing is to be 6 foot tall fencing, except for one fence length at Harriet Thompson is 4 foot tall and one fence length at the middle school is 8 feet tall.

KETCHUM ENTERPRISES INC.

project management

- XVII. Question: Does the District request extra material to be provided at project completion?
Answer: Yes, fifty (50) additional feet of each 6 foot tall color polymer coated fabric, five (5) additional post caps of each color and two (2) ten foot top rails of each color is to be provided at project completion for the District.
- XVIII. Question: Areas to receive mow strip along existing asphalt walks to be saw-cut?
Answer: Yes, areas along existing asphalt that receive a mow strip adjacent to it shall be saw cut in a straight linear path.
- XIX. Question: Areas to receive mow strip along existing concrete walks need to repair cracked and damaged concrete walk? Answer: Yes, at any area where mow strip is adjacent to a concrete walk, the existing concrete walk shall be repaired to be level and smooth along mow strip.
- XX. Clarification: All fence/gate hardware is to be installed on the “secure side” of fence.
- XXI. Clarification: Sod and soil is to be placed at the soil stockpile next to the maintenance shop.
- XXII. Clarification: Any demolition debris and materials, not including sod or soil, is to be removed off site by Contractor and disposed of in a licensed, bonded and EPA approved facility.
- XXIII. Clarification: Areas around existing fire hydrants shall receive a concrete slab infill between concrete curb and mow strip.
- XXIV. Clarification: City of Grandview Building/Fence Permit to be secured by Contractor.

PROJECT MANUAL:

Section 0000200 - Instructions to Bidders

1. Paragraph 1.35, **ADD** Line B., “REFERENCES: Contractor to provide a minimum of three references resulting from past fencing projects completed in the past five (5) years of similar scope and quality.”

DRAWINGS

1. **REPLACE** five (5) Drawings with attached five (5) drawings showing Addendum #1 clarifications or changes.
2. **ADD** attached Drawing “MSHT-SP” to contract document drawings (one sheet).

END OF ADDENDUM NO. 1

GRANDVIEW SCHOOL DISTRICT no. 200
DISTRICT FENCING PROJECT 2013 - PRE-BID WALKTHROUGH
AUGUST 12, 2013 | 10:00 am | SIGN IN SHEET

| | NAME | COMPANY | CITY / STATE | PHONE | EMAIL |
|----|-----------------|--------------------------|------------------|----------------|-------------------------------------|
| 1 | Spdy Smith | TC Fence | Red WA | 967-2911 | TC Fence@hotmail.com |
| 2 | Roy Masterson | NW Fence | Spokane WA | 928-8084 | roy@northwestfencecompany.com |
| 3 | Jon Johnson | Perimeter Security Group | Coeur d'Alene ID | (208) 755-2005 | jjohnson@perimetersecuritygroup.com |
| 4 | Josh Hinkle | Fencing And Awning | Yakima, WA | (509) 248-5117 | Josh@FencingAndAwning.com |
| 5 | Tom Wolkenhauer | Grview Schools | | 509-391-6111 | twolkenhauer@gsd200.org |
| 6 | GLENN BESTEBREW | BESTEBREW BROS | SUNNYSIDE WA | 509-840-9306 | GLENN@BESTEBREW.com |
| 7 | LATHAN WEDIN | KEI | | 509 250 3460 | Lathan@ketchumenterprisesinc.com |
| 8 | | | | | |
| 9 | | | | | |
| 10 | | | | | |
| 11 | | | | | |
| 12 | | | | | |
| 13 | | | | | |
| 14 | | | | | |
| 15 | | | | | |
| 16 | | | | | |
| 17 | | | | | |
| 18 | | | | | |
| 19 | | | | | |
| 20 | | | | | |

SHEET OF

SHEET OF

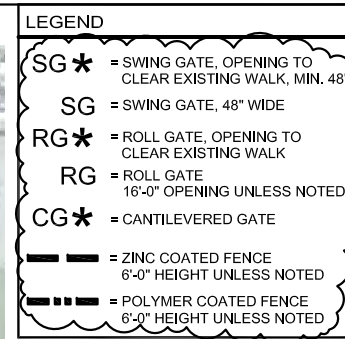
[illegible]

GRANDVIEW SCHOOL DISTRICT
913 W 2nd Street
GRANDVIEW, WA 98930

DATE AUGUST 14, 2013

© KETCHUM ENTERPRISES, INC.

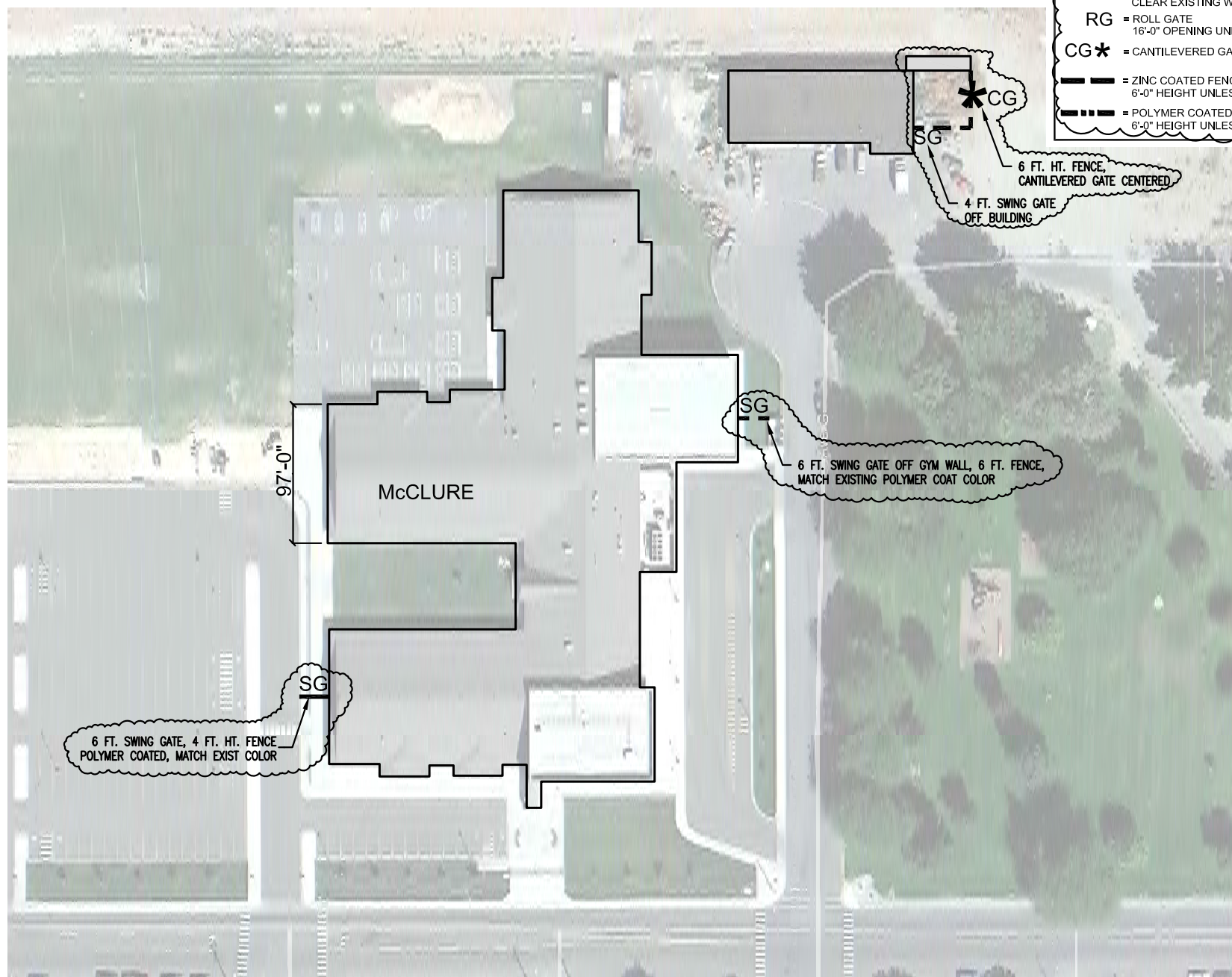

SEF-SP



McCLURE ELEMENTARY SCHOOL FENCING SITE PLAN

NORTH ↑

SCALE: 1:100

| LEGEND | |
|---|--|
| SG * | = SWING GATE, OPENING TO CLEAR EXISTING WALK, MIN. 48" |
| SG | = SWING GATE, 48" WIDE |
| RG * | = ROLL GATE, OPENING TO CLEAR EXISTING WALK |
| RG | = ROLL GATE 16'-0" OPENING UNLESS NOTED |
| CG * | = CANTILEVERED GATE |
|  | = ZINC COATED FENCE 6'-0" HEIGHT UNLESS NOTED |
|  | = POLYMER COATED FENCE 6'-0" HEIGHT UNLESS NOTED |

[illegible]

GRANDVIEW

SCHOOL DISTRICT

FENCING PROJECT 2013

GRANDVIEW SCHOOL DISTRICT
913 W 2nd Street
GRANDVIEW, WA 98930

| | |
|-----------|----------|
| PROJ. NO. | 2013K009 |
|-----------|----------|

DRAWN

CHECKED LAW

DATE AUGUST 14, 2013

© KETCHUM ENTERPRISES, INC.

MEF-SP

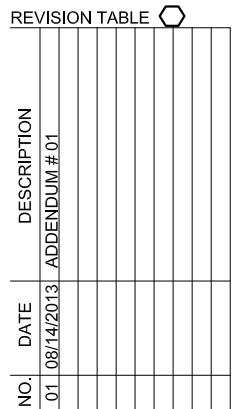

GRANDVIEW SCHOOL DISTRICT
913 W 2nd Street
GRANDVIEW, WA 98930

PROJ. NO. 2013K009
DRAWN
CHECKED LAW
DATE AUGUST 14, 2013

© KETCHUM ENTERPRISES, INC.

MSHT-SP

SHEET OF

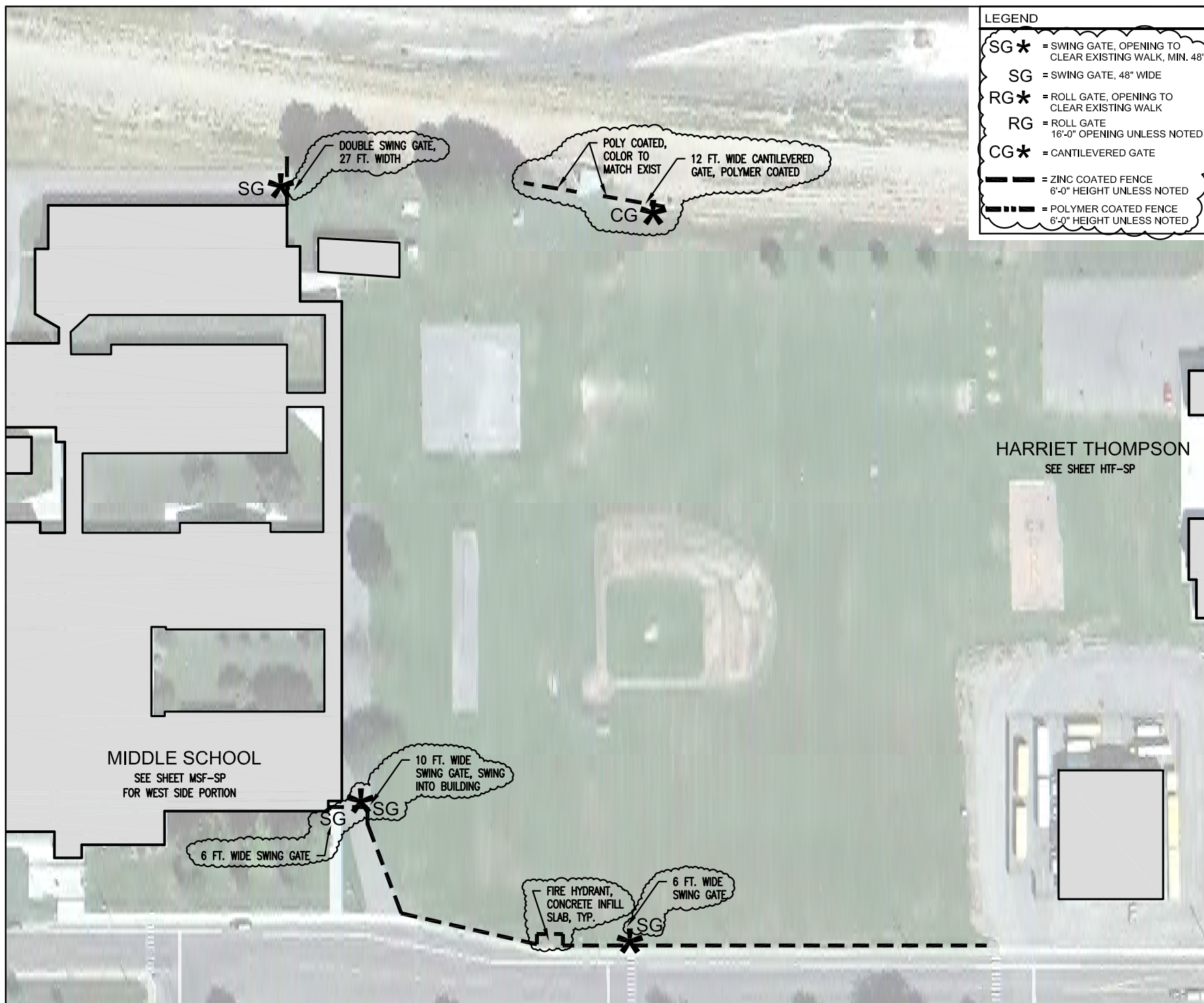

GRANDVIEW MIDDLE SCHOOL – HARRIET THOMPSON FENCING SITE PLAN

NORTH ↑

SCALE: 1:100